

Department	HydroLogic		Doc #	SOP – Flowmeter Cleaning	
Author:	B.Perryman	Date:	11/17/23	Revision No.	B
Checked By:		Date:		Date Issued:	3/7/25
Approved By:		Date:		No Pages:	2

Standard Operating Procedure (SOP); Flowmeter Cleaning

1. Purpose

The purpose of this SOP is to aid users in the general cleaning procedure for the HyperLogic Commercial Series RO flowmeters.

2. Applicable To

This SOP is applicable to all HyperLogic Commercial Series RO systems [1-12 membranes] featuring 'King' brand flowmeters.

3. Prerequisites

Ensure you follow all state & federal guidelines for personal workplace safety prior to disassembly and/or maintenance of your HyperLogic equipment and related consumables.

4. Materials/Reference

Suggested tools/materials required for this operation include, but may not be limited to, the following:

- Allen Wrench to fit top plug
- Small, Fine Bristle, Bottle Brush
- Mild Detergent, if needed
- Towels
- Warm, Fresh Water & Bucket

5. Procedure

The general steps for disassembly and cleaning of the HyperLogic RO flowmeters by 'King Instruments' are as follows:

- a. Place RO in 'Standby' or disconnect from power. Shut off feed water source to RO.
 - i. Ensure that all Pressure and Flow Gauges on the RO read '0'.
- b. Carefully remove the flowmeter from the piping system. Gently remove the 'Top Plug/Guide Rod' from the 'Acrylic Meter Block' using an Allen Wrench of appropriate size. All necessary instrument components are now fully accessible for cleaning with a small bottle brush and appropriate warm water/mild soap solution, if necessary*. Refer to 'Figure 1'.
 - i. *Do not use cleaning agents that will damage float, tube, or O-rings. Meters should be cleaned with a mild soap solution. This will be an effective cleaner of rust stains. Caution must be used so that materials of construction are not damaged by cleaning solutions. Hard water deposits can be removed with 5% acetic acid solution (vinegar).
 - ii. Thoroughly rise fittings to remove any residual cleaners used.
- c. Before the meter is reassembled, inspect all parts for damage. O-rings should be replaced during meter maintenance and cleaning.
- d. When installing float/guide assembly make certain that the end of the guide fully engages the inlet and/or outlet float stop.
- e. Reinstall and tighten any fittings removed during cleaning. **DO NOT OVERTIGHTEN FITTINGS!**
- f. Restore Power and Water to RO before resuming normal RO operation.

PARTS LIST:

1. Acrylic Meter Block
2. End Fitting O-Ring
3. Outlet End Fitting
4. Inlet End Fitting
5. Mounting Stud Assembly
6. Top Plug / Guide Rod
7. Float

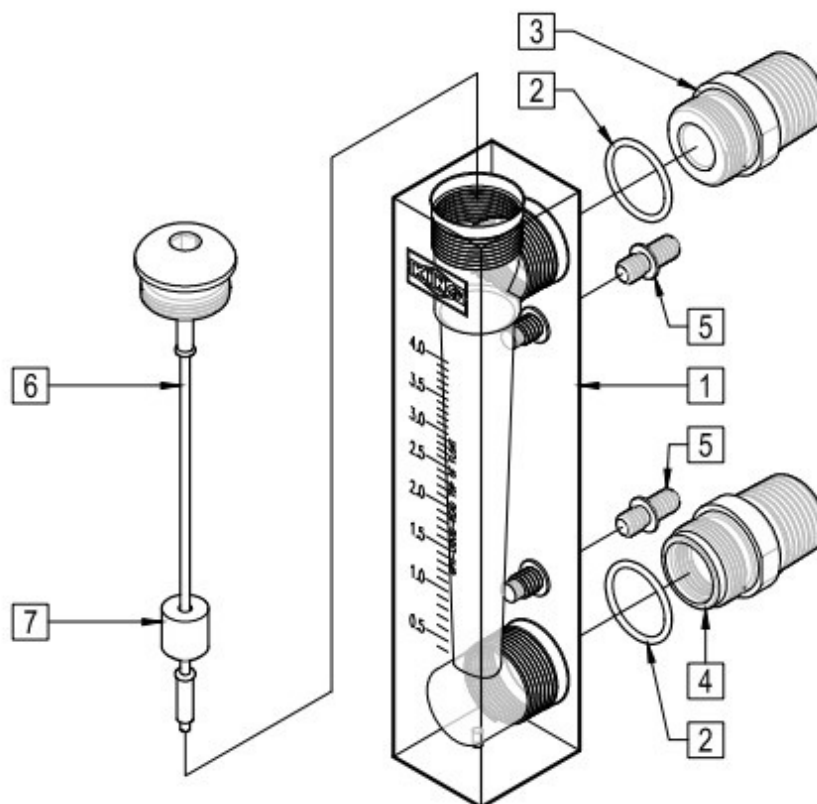

Figure 1



'King Instruments'
Flowmeters

END OF SOP DOCUMENT

Email hypertechsupport@hydrologicsystems.com